



SSB SBL 151-12HR (12V 764W)



Specification	
Nominal Voltage	12V
Nominal Capacity (10hr / 20°C / 1.80 V/C)	764W
	20 hour rate 145.0Ah
	10 hour rate 136.8Ah
Internal Resistance	Fully Charged battery 68°F(20°C) ≤4.5 mOhms
Self-Discharge	3% of capacity declined per month at 20°C (average)
	SSB series batteries may be stored for up to 6 months at 68°F(20°C) and then a freshening charge is required. For higher temperatures the time interval will be shorter.
Dimension	Length (mm / inch) 340 / 13.4 Width (mm / inch) 173 / 6.81 Height (mm / inch) 280 / 11.0 Total Height (mm / inch) 287 / 11.3
Approx. Weight (Kg / lbs)	43.0 / 94.8
Operating Temperature Range (temporarily – see our manual)	Discharge : -20~60°C Charge : -0~50°C Storage : -20~60°C
Max. Discharge Current 68°F(20°C)	1450A(5s)
Short Circuit Current	2900A
Charge Methods: Constant Voltage Charge 68°F(20°C)	Cycle use 2.30-2.35VPC Maximum charging current 0.96A Temperature compensation -3mV/°C Standby use 2.23-2.275VPC Temperature compensation -4mV/°C
Life expectancy	10~12 years at 20°C with charge voltage 2.25V/cell

Applications

- ◆ Absorbent Glass Mat (AGM) technology for efficient gas recombination of up to 99% and freedom from electrolyte maintenance or water adding.
- ◆ Not restricted for air transport-complies with IATA/ICAO Special Provision A67.
- ◆ UL-recognized component.
- ◆ Can be mounted in any orientation.
- ◆ Computer designed lead, calcium tin alloy grid for high power density.
- ◆ Long service life, float or cyclic applications.
- ◆ Maintenance-free operation.
- ◆ Low self discharge.
- ◆ Case and cover available in both standard and flame retardant ABS.



Conform to:
IEC60896-21&22 and/or IEC61427

Discharge Constant Current (Amperes at 68°F20°C)

End Point Volts/Cell	5min	8min	10min	15min	20min	30min	60min	90min
1.60V	492.1	421.4	379.0	301.8	241.8	177.3	101.9	75.5
1.65V	455.3	395.3	355.6	285.4	225.6	169.0	97.1	71.9
1.70V	436.4	381.4	342.7	276.6	217.0	164.2	94.3	69.7
1.75V	412.2	362.3	321.8	263.6	211.1	159.6	92.8	68.1
1.80V	387.7	343.2	300.8	250.4	204.8	154.7	91.0	66.5
1.85V	361.8	322.7	278.9	236.2	197.7	149.0	88.8	64.5

Discharge Constant Current (Watts at 68°F20°C)

End Point Volts/Cell	5min	8min	10min	15min	20min	30min	60min	90min
1.60V	868	755	683	551	445	327	188	140
1.65V	811	715	647	528	419	314	181	135
1.70V	787	698	631	518	407	309	178	132
1.75V	753	671	600	499	401	304	178	131
1.80V	718	645	569	481	395	299	177	130
1.85V	684	619	538	463	389	294	176	128

Dimensions

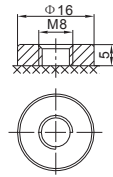
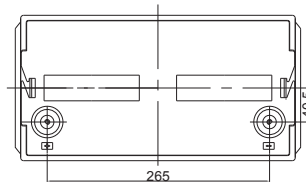
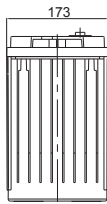
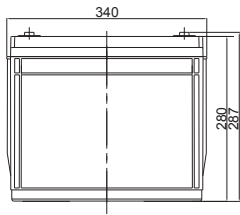

F12 Terminal

Discharge Characteristics

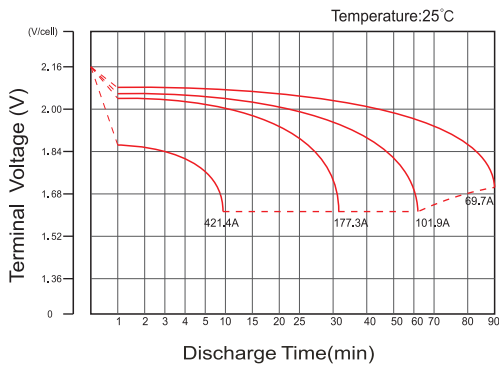

Float Charging Characteristics

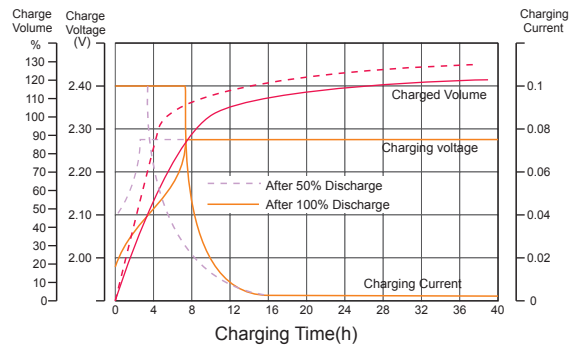

Temperature Effects in Relation to Battery Capacity

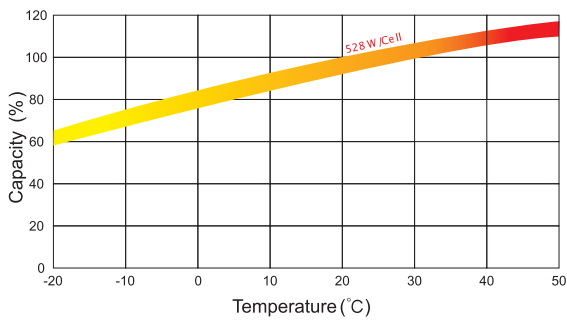

Effect of Temperature on Long Term Float Life

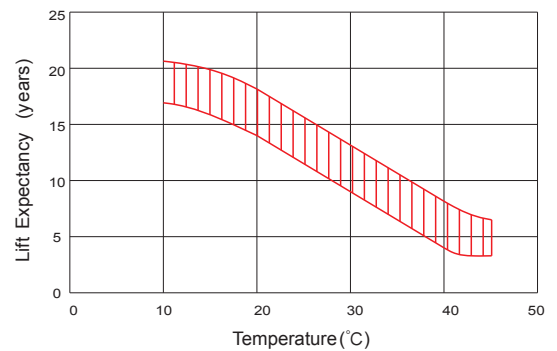

Cycle Life in Relation to Depth of Discharge

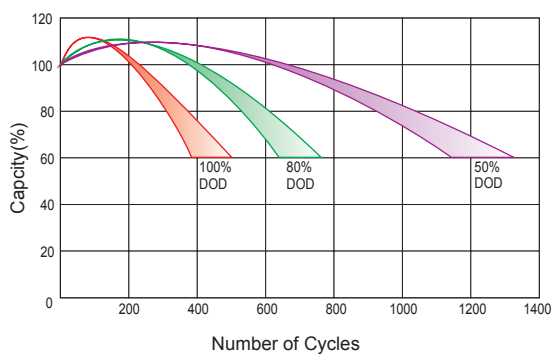

Self Discharge Characteristics

