



# SSB SBL 135-12HR (12V 683W)

## Specification

Nominal Voltage	12V	
Nominal Capacity (5min / 20°C / 1.80 V/C)	683W	
	20 hour rate	120.0Ah
	10 hour rate	113.2Ah
Internal Resistance	Fully Charged battery 68°F(20°C)	≤4.0 mOhms
Self-Discharge	3% of capacity declined per month at 20°C (average)	
Dimension	Length (mm / inch)	407 / 16.0
	Width (mm / inch)	177 / 6.97
	Height (mm / inch)	225 / 8.86
	Total Height (mm / inch)	225 / 8.86
	Approx. Weight (Kg / lbs)	38.0 / 83.8
Operating Temperature Range (temporarily – see our manual)	Discharge :	-20~60°C
	Charge :	-0~50°C
	Storage :	-20~60°C
Max. Discharge Current 68°F(20°C)	1200A(5s)	
Short Circuit Current	3000A	
Charge Methods: Constant Voltage Charge 68°F(20°C)	Cycle use	2.30-2.35VPC
	Maximum charging current	0.96A
	Temperature compensation	-3mV/°C
	Standby use	2.23-2.275VPC
	Temperature compensation	-4mV/°C
Life expectancy	10~12 years at 20°C with charge voltage 2.25V/cell	



## Applications

- ◆ Absorbent Glass Mat (AGM) technology for efficient gas recombination of up to 99% and freedom from electrolyte maintenance or water adding.
- ◆ Not restricted for air transport-complies with IATA/ICAO Special Provision A67.
- ◆ UL-recognized component.
- ◆ Can be mounted in any orientation.
- ◆ Computer designed lead, calcium tin alloy grid for high power density.
- ◆ Long service life, float or cyclic applications.
- ◆ Maintenance-free operation.
- ◆ Low self discharge.
- ◆ Case and cover available in both standard and flame retardant ABS.



Conform to:  
IEC60896-21&22 and/or IEC61427

## Discharge Constant Current (Amperes at 68°F20°C)

End Point Volts/Cell	5min	8min	10min	15min	20min	30min	60min	90min
1.60V	424.2	363.3	326.7	259.5	208.5	152.8	87.9	65.1
1.65V	392.5	340.8	306.6	246.0	194.5	145.7	83.7	62.0
1.70V	376.2	328.8	295.5	238.4	187.1	141.6	81.3	60.1
1.75V	355.3	312.3	277.5	227.3	181.9	137.6	80.0	58.7
1.80V	334.2	295.9	259.3	215.9	176.6	133.4	78.4	57.3
1.85V	311.9	278.2	240.4	203.6	170.4	128.4	76.5	55.6

## Discharge Constant Current (Watts at 68°F20°C)

End Point Volts/Cell	5min	8min	10min	15min	20min	30min	60min	90min
1.60V	757	657	595	475	383	282	162	121
1.65V	707	623	563	455	361	271	156	116
1.70V	686	608	550	446	351	266	154	114
1.75V	656	585	523	431	346	262	153	113
1.80V	626	562	496	415	341	258	152	112
1.85V	596	539	469	399	335	253	152	111



# Dimensions

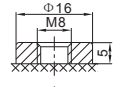
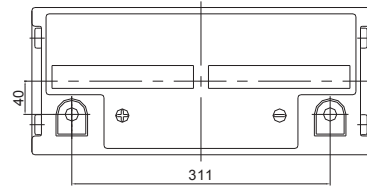
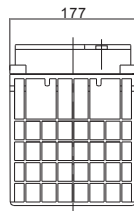
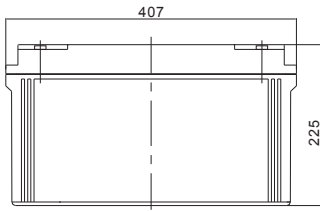

F12 Terminal

## Discharge Characteristics

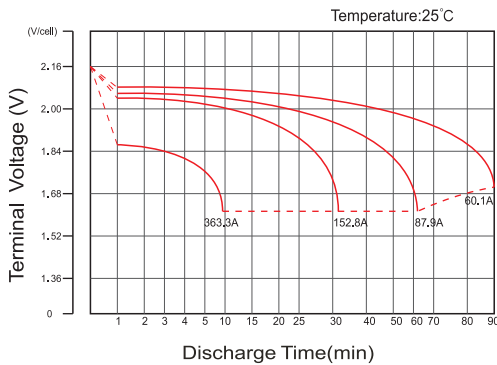

## Float Charging Characteristics

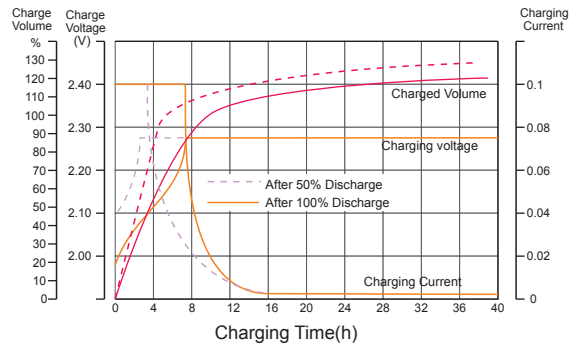

## Temperature Effects in Relation to Battery Capacity

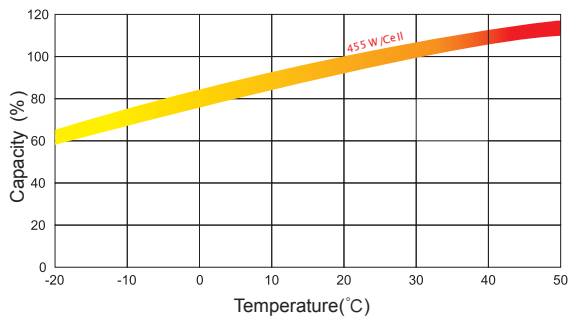

## Effect of Temperature on Long Term Float Life

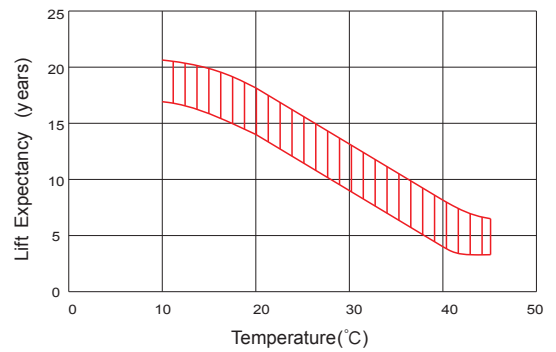

## Cycle Life in Relation to Depth of Discharge

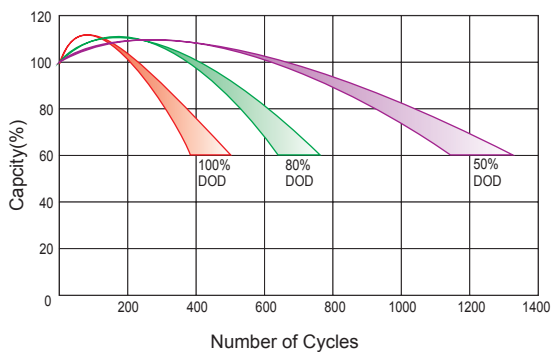

## Self Discharge Characteristics

